

Department of Engineering
Tim Bryan, P.E., PTOE, County Engineer

3137 South Liberty Street, Canton, MS 39046
Office (601) 855-5582 FAX (601) 859-5857

MEMORANDUM

January 22, 2024

To: Casey Brannon, Supervisor, District I
Trey Baxter, Supervisor, District II
Gerald Steen, Supervisor, District III
Karl Banks, Supervisor, District IV
Paul Griffin, Supervisor, District V

From: Tim Bryan, P.E., PTOE
County Engineer

Re: AT&T Utility Permit
County Road Name, Yandell Road

The Engineering Department recommends approval for the permit application for AT&T Utility to dbore 618' of buried fiber cable from Cedar Grove Lane to Porter Ridge and the County Roads listed below.

- Magnolia Pointe Drive
- Porter Ridge Drive

CASEY BRANNON
District One

TREY BAXTER
District Two

GERALD STEEN
District Three

KARL M. BANKS
District Four

PAUL GRIFFIN
District Five

Revised: 2/14/2019



PERMIT APPLICATION FOR THE CONSTRUCTION OR ADJUSTMENT OF A UTILITY WITHIN COUNTY ROAD RIGHT-OF-WAY

Utility Information: Utility Name: AT&T Mississippi

Address: 370 Church Rd City/State/Zip: Madison

Contact Person: Lori Allen Contact's Phone: 769-229-1355

Project Information: County Road Name: Yandell Rd

(If located within more than one road right-of-way, use Appendix 1 for additional descriptions)

Beginning Location: Cedar Grove Ln Ending Location: Porter Ridge

Length of Project: 432' Section: 25 Township: T8N Range: R2E

Description of Work: Dboꝛ 1200' of buried fiber cable from Cedar Grove Ln to Porter Ridge.



Check Box if Appendix 1 is to be included as a part of this Application

Whereas the above stated Utility makes application to the **Madison County Board of Supervisors** for a Construction Permit. Attached hereto are drawings and plans for the construction of the above facilities located within Madison County owned public rights-of-way. Once stamped by the Madison County Engineering Department, these plans shall not be changed or altered without written approval of the County Engineer, or his representative. A copy of the approved permit and plans shall be on-site at all times during construction.

The Applicant Utility shall comply with all policies, procedures and construction practices as outlined in *A Policy for The Accommodation of Utility Facilities within the Right-of-Way of all Public County Roads* (hereinafter referred to as the "Policy"), as adopted on November 1, 2005, by the **Madison County Board of Supervisors**, and which is hereby made a part of this Application Agreement.

If facilities are to be located within the Rights-of-Way of the County-Federal or State Aid System, Applicant Utility also agrees to comply with applicable provisions of *S.O.P. No. SA II-2-8, Accommodation of Utilities on Rights-of-Way*, issued by the State Aid Engineer and dated July 1, 2005.

The Applicant Utility understands and agrees that, except as herein granted, no right, title, claim, or easement to said road right-of-way is granted by the issuance of this permit. If this Utility is listed in the general provisions of the Policy, it will be adjusted to comply with same without cost to the County, unless the variance from the Policy has been approved by the granting of the Permit pursuant to this Application.

The Applicant Utility further understands that the Utility's engineering, plant, or other personnel will be responsible for the staking and construction supervision of the work set out above and as shown on the attached plans. If work impacts traffic in any way, the appropriate traffic control shall be installed per the *Manual of Uniform Traffic Control Devices*, Latest Edition.

The Applicant Utility understands that the County Engineer, or his representative, may issue a Stop Work Order at any time if it is deemed that site conditions are not suitable for construction or if any of the requirements of this permit are not being met.

Many County Roads have variable Rights-of-Way and/or no Right-of-Way at all and are maintained under a Prescriptive Easement. It is the sole responsibility of the Applicant Utility to verify the existence and limits of public rights-of-way. If none exists, it is the

responsibility of the Applicant Utility to acquire an easement for their Facilities from the applicable property owner(s). Madison County in no way verifies the limits of Right-of-Way as shown on the permit application.

The Applicant Utility shall be responsible for all future maintenance and repair of the facilities installed under this permit. The Applicant Utility shall make future adjustments to, or relocate, the facilities located within road or highway right-of-way when required for road or highway widening or other road or highway construction at no cost to Madison County. The Applicant Utility shall relocate said utilities within sixty (60) days of notification by County by registered mail, return receipt requested, unless otherwise designated by the County Engineer. Further, any maintenance, repair, or construction shall be done in such a manner as to occasion no unreasonable interference with the normal flow and safety to traffic and at the expense of the utility company. When reasonable care has been taken to locate said utility facilities within the right-of-way, the Applicant Utility understands that any damages caused by routine maintenance and construction by County forces shall be borne by the Applicant Utility.

The Applicant Utility further agrees to indemnify and hold Madison County harmless for any and all claims, accidents, damages, liabilities and expenses occasioned wholly, or in part, by any act or omission of applicant, its agents or employees. In case County shall, without fault on its own part, be made a party to any litigation commenced by or against applicant, then applicant shall protect and hold County harmless, and shall pay all costs, expenses and reasonable attorney's fees incurred or paid by County in connection with said litigation.

All underground facilities shall be installed at a depth equal to or greater than 48" below the lowest adjacent grade.

All pipes carrying liquid shall be encased under County maintained roads.

WITNESS the signature of the Applicant this the 11 Jay of January, 2024.

By: Lori Gyor
(Applicant Signature)

Title: OSP Engineering

Note: Applicant must be an employee of the Utility named in this application. The Madison County Board of Supervisors will not recognize a Contractor, Subcontractor, Agent, or Consulting Engineer as the Applicant. Utility Company shall be fully responsible for all work performed under this application.

I, or my authorized representative, have reviewed this application and determined that the drawing, sketches, and plans submitted by the Applicant meet the requirements of A Policy for The Accommodation of Utility Facilities within the Right-of-Way of all Public County Roads.

APPROVED

By: **By timothy.bryan at 12:28 pm, Jan 31, 2024**

By: Tim Bryan, P.E.
County Engineer

AGREED TO AND APPROVED BY:

Madison County Board President

Date: _____

ENTERED INTO THE MINUTES OF THE BOARD OF SUPERVISORS OF MADISON COUNTY, MISSISSIPPI ON THIS

_____ DAY OF _____, 20_____.

Appendix 1

County Road Name: Magnolia Pointe Dr

Beginning Location: Yandell Rd Ending Location: Porter Ridge Rd

Length of Project: 135' Section: 25 Township: T8N Range: R2E

Description of Work: Dbore buried fiber cable along Magnolia Pointe Dr

County Road Name: Porter Ridge Dr

Beginning Location: Magnolia Pointe Dr Ending Location: Porter Ridge

Length of Project: 632' Section: 25 Township: T8N Range: R2E

Description of Work: Dbore buried fiber cable along Porter Ridge Dr

County Road Name: _____

Beginning Location: _____ Ending Location: _____

Length of Project: _____ Section: _____ Township: _____ Range: _____

Description of Work: _____

County Road Name: _____

Beginning Location: _____ Ending Location: _____

Length of Project: _____ Section: _____ Township: _____ Range: _____

Description of Work: _____

County Road Name: _____

Beginning Location: _____ Ending Location: _____

Length of Project: _____ Section: _____ Township: _____ Range: _____

Description of Work: _____

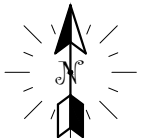

LOCATION MAP: 120 PORTER RIDGE, CANTON, MS 39046, USA

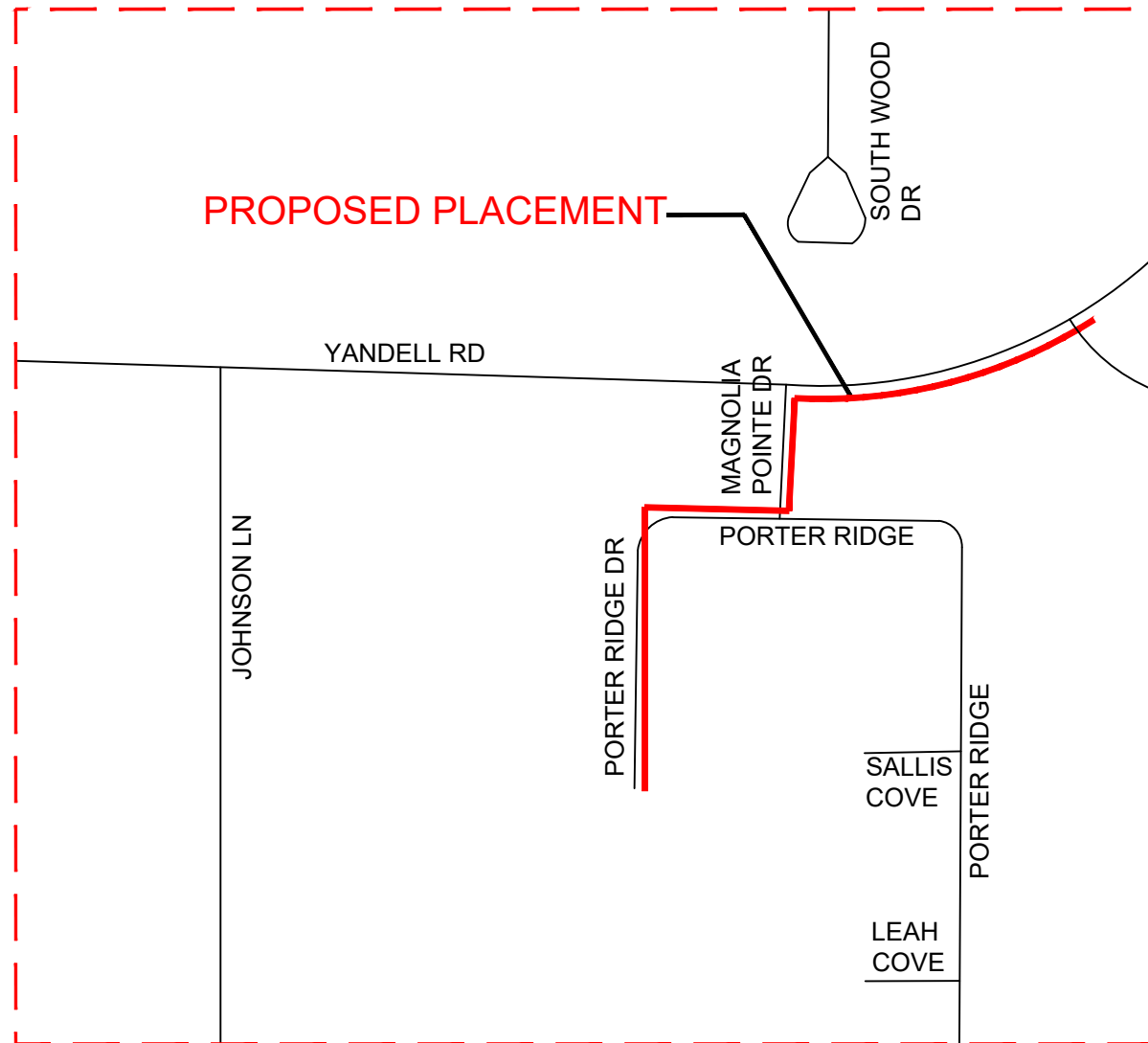

LOCATION MAP

LEGEND	
SYMBOLS	DESCRIPTION
	PROPOSED BURIED CABLE
	PROPOSED INNERDUCT
	EXISTING HANDHOLE
	PROPOSED BORE PIT
	PROPOSED 10X15X12 HANDHOLE
	RIGHT OFF WAY
	BACK OF CURB
	EDGE OF PAVEMENT
	CENTER LINE



CAUTION
VOLTS TO GROUND
301V-15kV

CALL BEFORE YOU DIG

MISSISSIPPI DIAL 811

TWO FULL BUS. DAYS BEFORE YOU DIG

IT IS THE CONTRACTORS RESPONSIBILITY TO CONTACT UTILITY COMPANIES PRIOR TO ANY CONSTRUCTION AS THE LOCATION OF UTILITIES SHOWN ON THIS PLAN ARE APPROXIMATE AND POSSIBLY INCOMPLETE. THEREFORE CERTIFICATION TO THE LOCATION OF ALL UNDERGROUND UTILITIES IS WITHHELD.

DATE:	11/30/2023	VERSION:	1
ATTSE			
PROPOSED TELEPHONE FACILITIES ON RIGHT OF WAY MADISON COUNTY 120 PORTER RIDGE			
Exchange:	601856		
Designer:	ALLEN, LORI		
Phone:	769-229-1355		
Authorization:	A02PT40		
Dwg.	1	of	5

-Project names: EWO- A02PT40
-Service Provider name: AT&T

- Description of proposed work to include:
- Linear feet of underground placement: 1533'
- Linear feet of Aerial placement: 0'
- Number of proposed anchors and guys: 0
- Depth of utility to be installed (Parallel to Road): 48"
- Depth of utility to be installed (Under Road/Pavement): 48"
- Number of HANDHOLE /pull boxes/vaults to be installed: 6
- Number of sidewalk breaks: 0

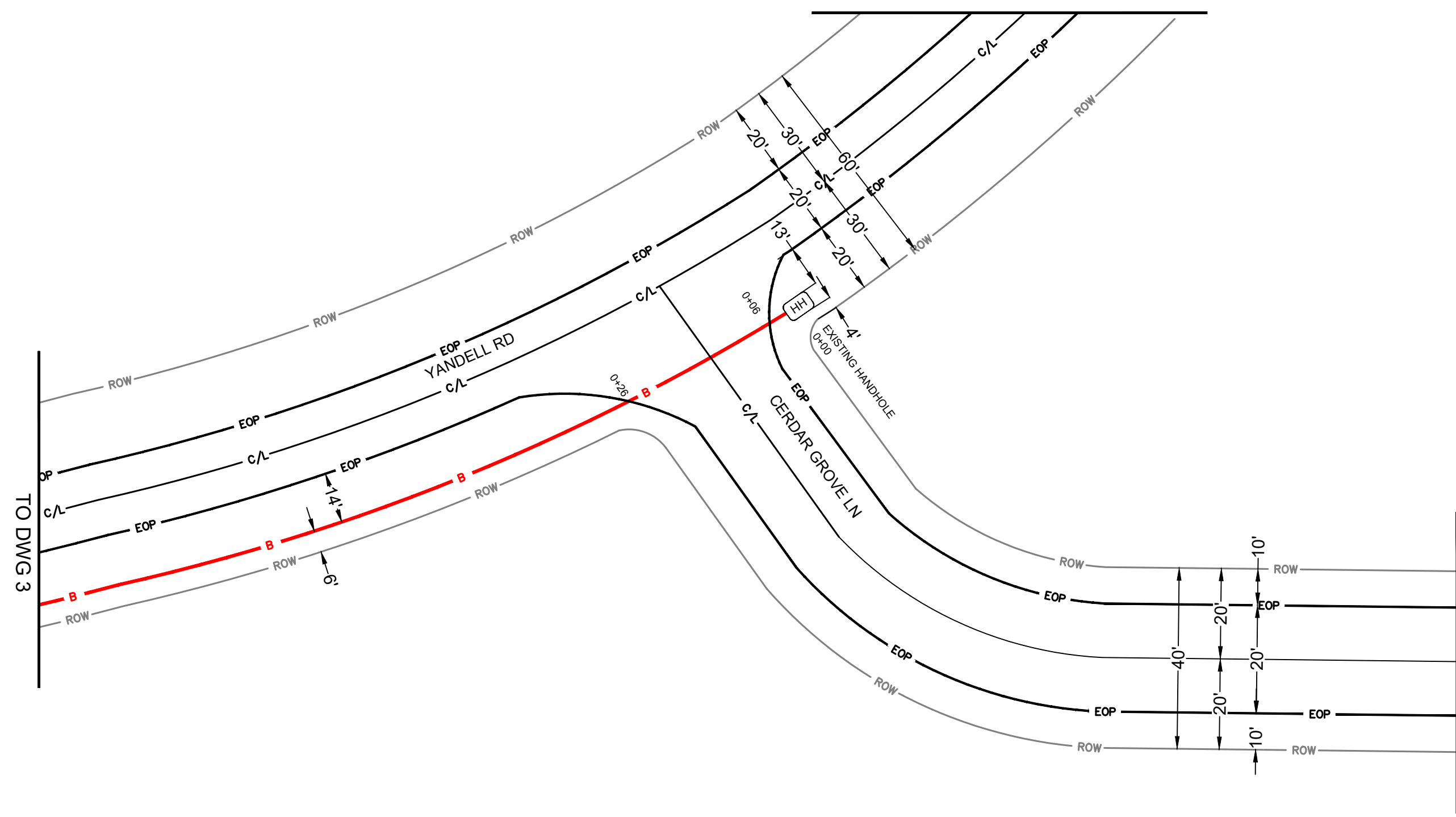

- B — PROPOSED AT&T BURIED FIBER INSTALLED @ 48" MIN DEPTH.
- HH EXISTING HANDHOLE

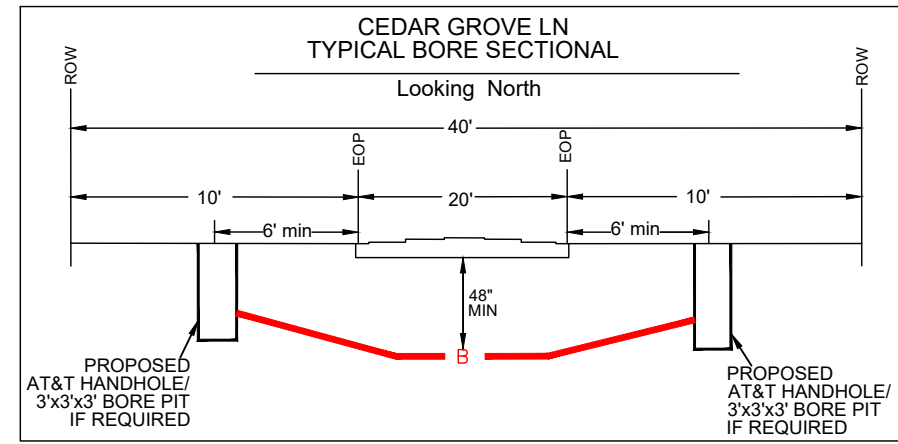

ATTSE	
PROPOSED TELEPHONE FACILITIES ON RIGHT OF WAY MADISON COUNTY 120 PORTER RIDGE	
Exchange:	601856
Designer:	ALLEN, LORI
Phone:	769-229-1355
Authorization:	A02PT40
Dwg.	2 of 5

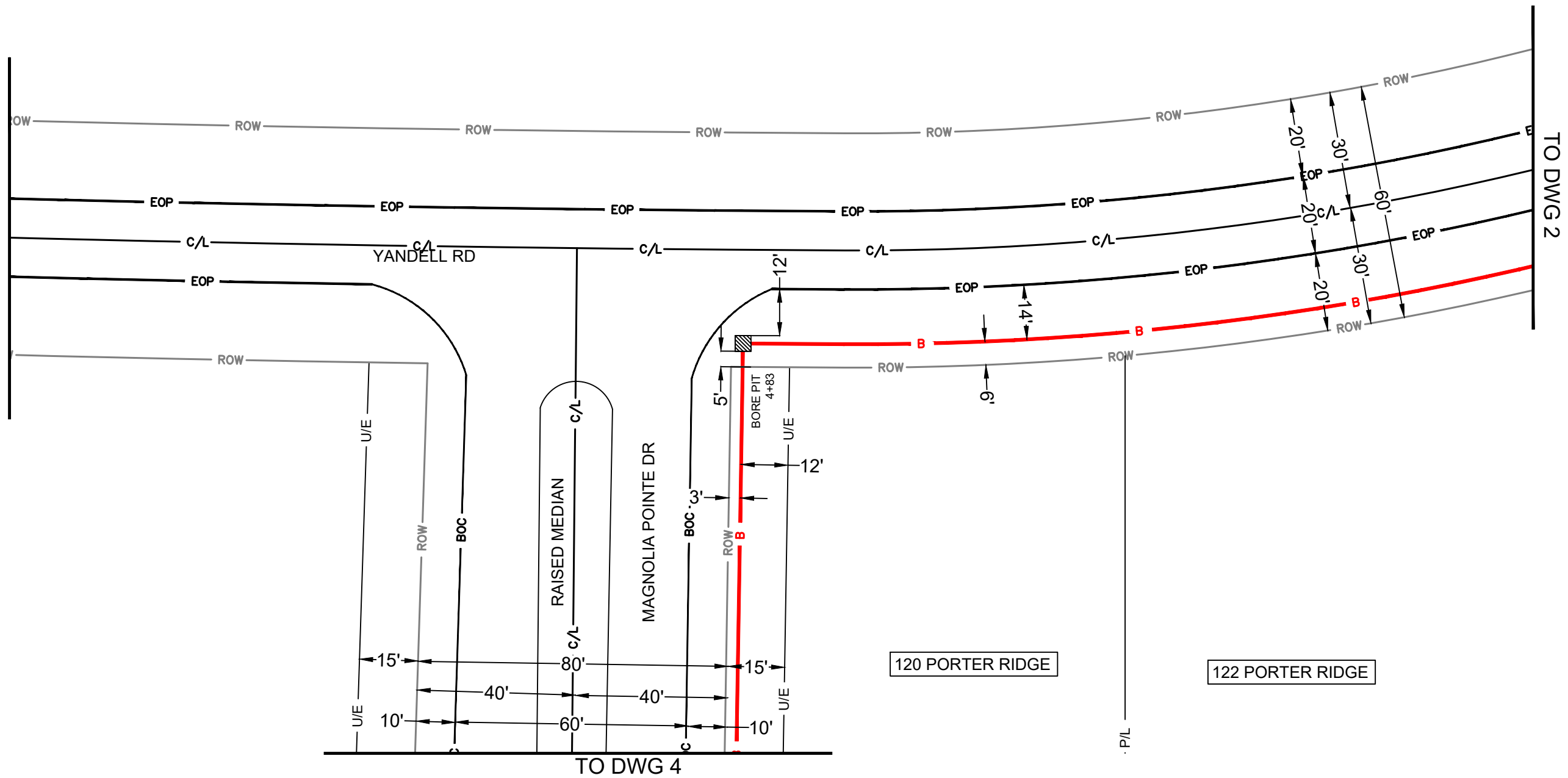

PROPOSED AT&T BURIED FIBER
INSTALLED @ 48" MIN DEPTH.



DIG PIT (3'X3'X3') REMOVE AND
RESTORE 25SF OF GRASS AREA
TO EQUAL OR BETTER CONDITION.

120 PORTER RIDGE

122 PORTER RIDGE

ATTSE

PROPOSED TELEPHONE FACILITIES
ON RIGHT OF WAY
MADISON COUNTY
120 PORTER RIDGE

Exchange:
601856

Designer:
ALLEN, LORI

Phone:
769-229-1355

Authorization:
A02PT40

Dwg. 3 of 5

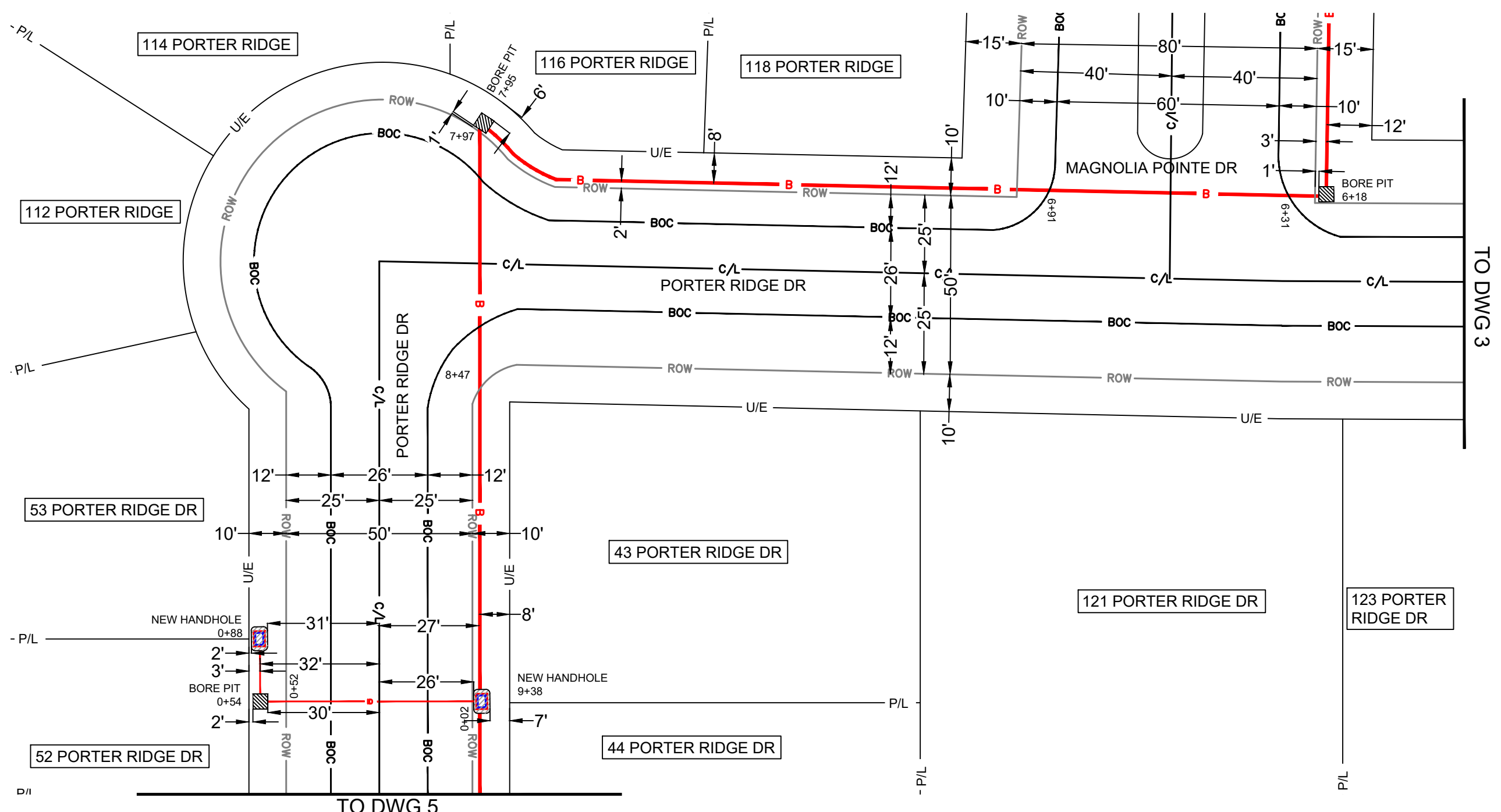

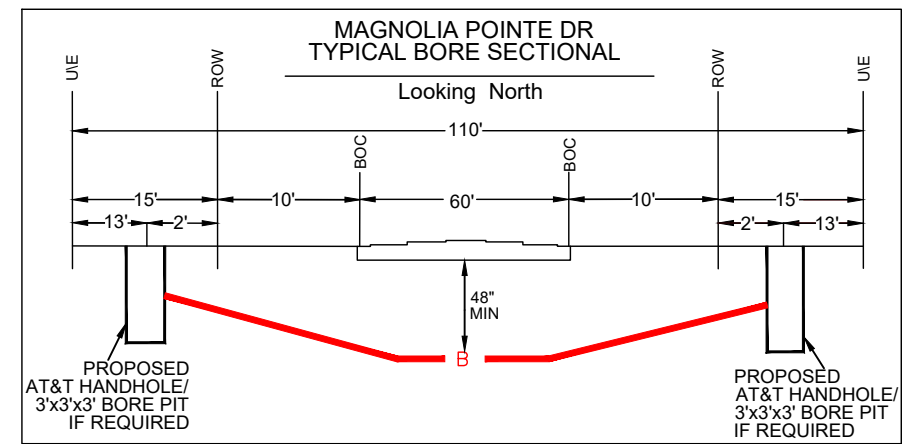
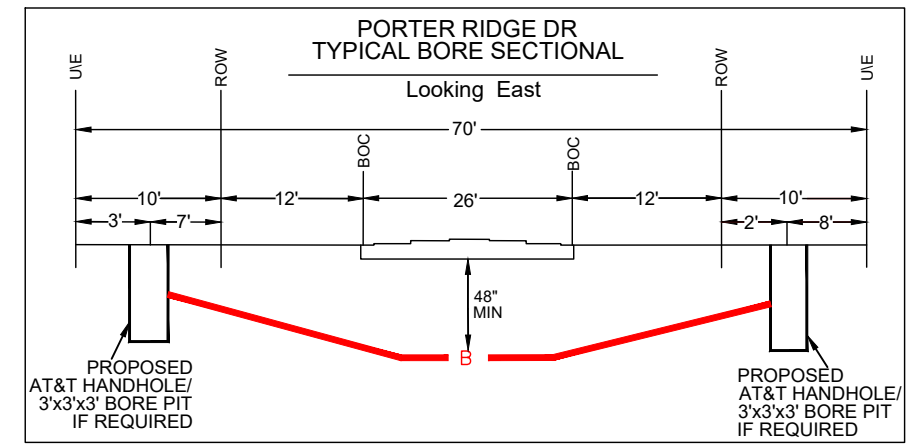

- B — PROPOSED AT&T BURIED FIBER INSTALLED @ 48" MIN DEPTH.
- DIG PIT (3'X3'X3') REMOVE AND RESTORE 25SF OF GRASS AREA TO EQUAL OR BETTER CONDITION.
- ID — PROPOSED AT&T 1.5" INNERDUCT INSTALLED @ 48" MIN DEPTH.

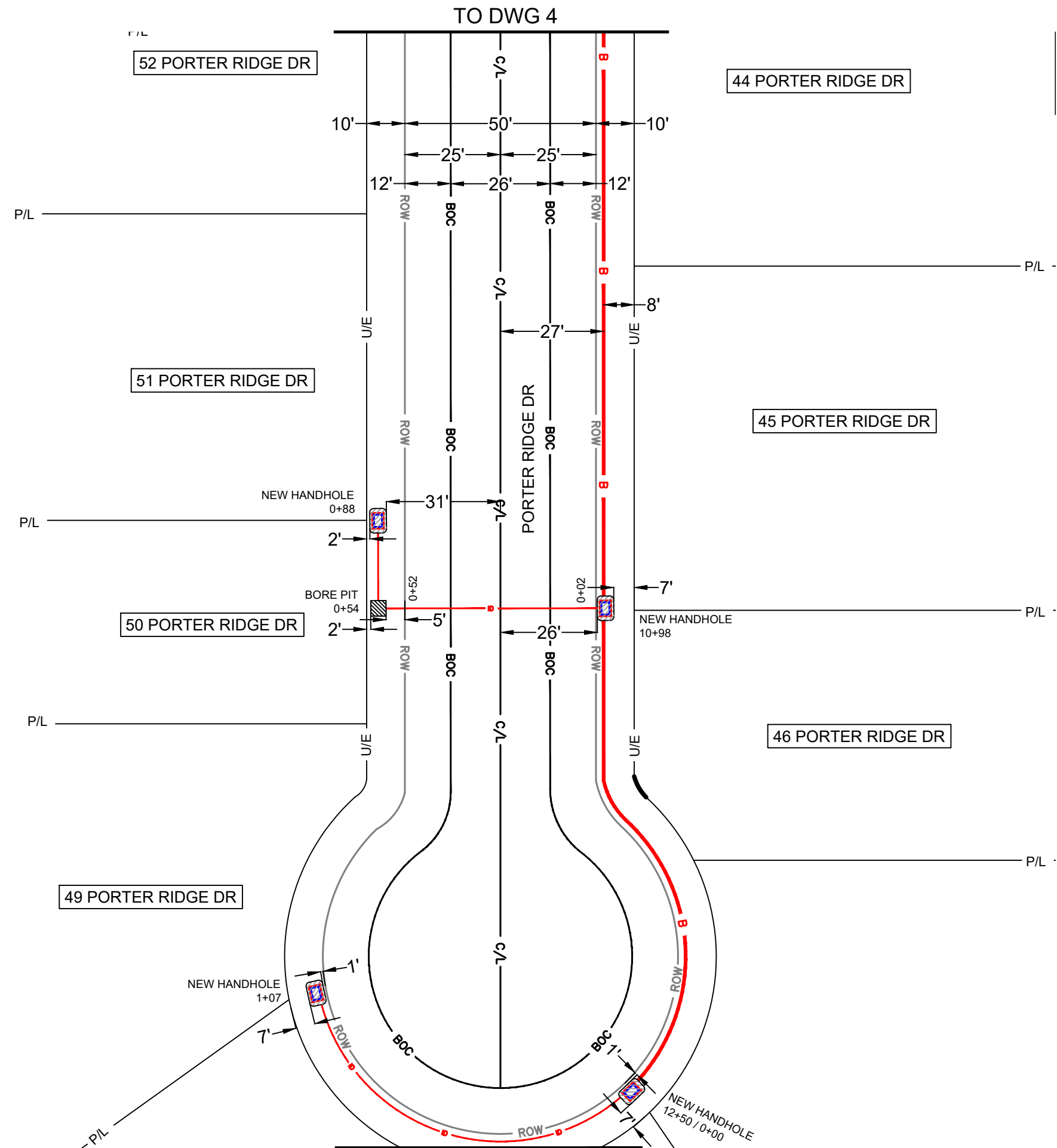
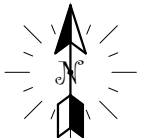

ATTSE	
PROPOSED TELEPHONE FACILITIES ON RIGHT OF WAY MADISON COUNTY 120 PORTER RIDGE	
Exchange:	601856
Designer:	ALLEN, LORI
Phone:	769-229-1355
Authorization:	A02PT40
Dwg.	4 of 5



- B — PROPOSED AT&T BURIED FIBER INSTALLED @ 48" MIN DEPTH.
-  INSTALL 1-10"Wx15"Lx12"D HANDHOLE REMOVE AND RESTORE 35SF OF GRASS AREA TO EQUAL OR BETTER CONDITION
-  DIG PIT (3'X3'X3') REMOVE AND RESTORE 25SF OF GRASS AREA TO EQUAL OR BETTER CONDITION.
- ID — PROPOSED AT&T 1.5" INNERDUCT INSTALLED @ 48" MIN DEPTH.

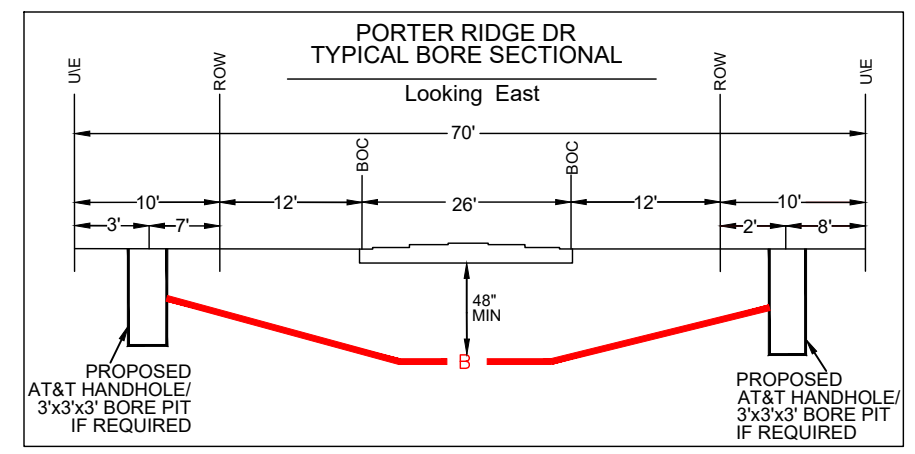

ATTSE	
PROPOSED TELEPHONE FACILITIES ON RIGHT OF WAY MADISON COUNTY 120 PORTER RIDGE	
Exchange:	601856
Designer:	ALLEN, LORI
Phone:	769-229-1355
Authorization:	A02PT40
Dwg.	5 of 5